



### ORDER MATRIX | Example: AL4-VA1

A	B	C	D	E	F	G
<b>A</b>	Series					
<b>AL4-VA1</b>	4" Architectural Downlight LED					
<b>B</b>	Input Voltage					
	120V					
<b>277</b>	277V					
<b>U</b>	120-277V					
<b>C</b>	LED Available					
<b>Cree</b>	Cree					
<b>Citizen</b>	Citizen					
<b>Epistar</b>	Epistar					
<b>Seoul</b>	Seoul					
<b>Osram</b>	Osram					
<b>D</b>	Dimmable					
	Non-Dimmable					
<b>DM</b>	Dimmable					
<b>E</b>	Wattage					
<b>L11</b>	11W					
<b>L15</b>	15W					
<b>L18</b>	18W					
<b>L25</b>	25W					
<b>F</b>	Color Temperature					
<b>30K</b>	3000K					
<b>40K</b>	4000K					
<b>50K</b>	5000K					
<b>G</b>	Options					
<b>EM</b>	Emergency Backup					
<b>C</b>	C-Channel Bar Hanger					
<b>F</b>	Flat Bar Hanger					
<b>H</b>	Wood Joist Bar Hanger					

### Reflector Matrix

A	B	C
<b>A</b>	Trim	
<b>SF</b>	Self Flanged	
<b>SFW</b>	Self Flanged White NO Flange	
<b>C</b>	Lens Type	
<b>CR</b>	Clear Tempered	
<b>SB</b>	Sand Blasted	
<b>B</b>	Reflector Finish	
<b>C</b>	Clear	
<b>HZ</b>	Haze	
<b>WH</b>	White	

## 4" Architectural LED Downlight

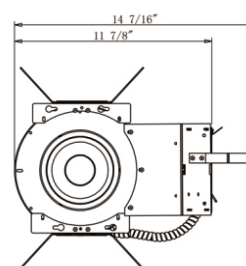
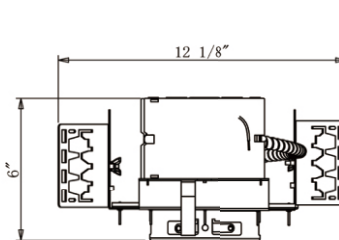

### Description

- Lighting is smooth and comfortable while using 50% less energy than the common CFL downlight.
- Eco-friendly no lead or mercury
- Designed to install into an existing downlights mounting frame and convert them into energy efficient LED downlights to save anywhere from 35% up to 75% on energy cost.
- Ideal suited for use in commercial, retail and other architectural applications
- Available with dedicated Emergency Battery Back-up

### Reflector

- High quality reflector with 1.2mm thickness
- Optional painted white flange is available

### Reflector Assembly

- Reflector easily wires to dedicated frame with locking quick connect

### LED Module

- Cree true white® technology available
- CRI>80%
- Color temperature: 3000K-5000K
- Rated for 50000 hours at 70% lumen output
- No heat, mercury or UV

### Electrical System

- Thermal protection guard protects the LED module from overheating and will dim LED module if necessary
- PF>0.9
- Fully dimmable down to 10% of initial light output with a 0-10 Volt dimmer

Input Power	Lumens
11W (+/- 5%)	900LM
15W (+/- 5%)	1200LM
18W (+/- 5%)	1500LM
25W (+/- 5%)	2000LM

### Listing

- ETL listed for damp location W/Feed through

### Frame

- Constructed from 16-gauge steel, die-formed construction for max heat dissipation and rust protection.

### Clearance

- Frames require a minimum clearance of 3" ring from thermal insulation and 1/2" from adjacent building component.

### Mounting

- Designed to install into an existing downlights mounting frame and convert them into energy efficient LED downlights.
- Flex is designed to attach into existing junction box.
- Vertically adjustable universal mounting brackets accept flat bar hangers, conduit or C-channel
- The reflector assembly is held in with 4 "butter-fly" spring clips.
- Reflector assy quickly attaches with lockable quick connect. Hanger bars ordered separately.
- Compatible with C-channel, flat bar wood joist bar hanger and EMT

### Junction Box

- Plaster frame integrated 29 cubic inch 0.064" thick galvanized steel
- Provided with four 1/2" knockouts, one 3/4" knockout and four Romex knockouts with true pryout slots and strain clamps.
- Designed for straight through conduit runs.
- Electrical connections are made through a single junction box door.
- Green wire provided for installation with ground wire fed through PVC pipe conduit.

### Thermal Protector

- External thermal device is located on the junction box wrap.

### Driver

- The LED driver is mounted to the J-box cover and is accessible from below the ceiling.
- Rated for 50Hz to 60Hz at 120V/277V input
- Produces less than 20% THD



**Accent Design Concepts, LLC.**

Orlando, Florida 32824

Email: Sales@accentdesignconcepts.com

Website: [www.accentdesignconcepts.com](http://www.accentdesignconcepts.com)

Specifications subject to change w/o notice